

# HAUNTED HOUSE

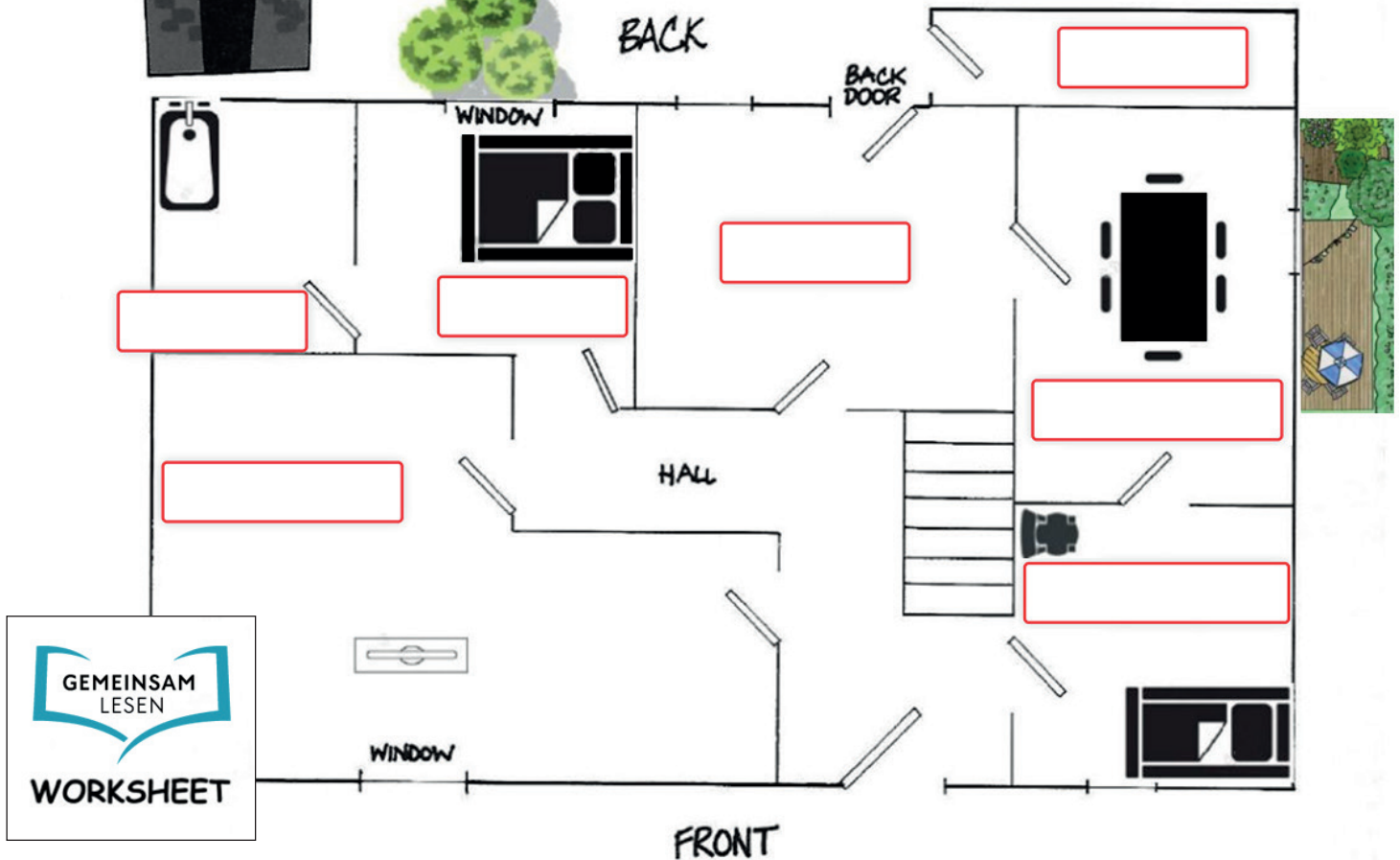

[http://bit.ly/gl\\_hal07](http://bit.ly/gl_hal07)

Haunted House interaktiv  
+ Auflösung



Look at the plan of Wilma's house. Read the description. Drag the names of the rooms into the correct boxes:

Go through the front door into the HALL. There's a door on the right. Go through that door. You are in my **GRANDMOTHER'S ROOM**. There's a window on the right. On the left there is another door.

Go through the door. You are in the **DINING ROOM**. On the right there is a window. Go over to the window. You can see the small garden. There is a table with six chairs in the room.

Opposite the window, there's a door to the **KITCHEN**. The kitchen has three doors. The door to the right is next to a window. There is a small room to the right of the back door.

Our cat, Spook, sleeps here. It's **SPOOK'S ROOM**.

Go back to the HALL. The next door to the right is the door to my **PARENTS' ROOM**. There is a window opposite the door. Go to the window. You can see three big trees. My parents' bed is near the window.

There's a small **BATHROOM** next to my parents' room. Our snake, Sylvia, lives in the bath.

The big room is the **LIVING ROOM**. There's a television near the window.

